

General Offices: Municipal Building
SPRINGFIELD, ILLINOIS 62701



JIM HENNEBERRY, Commissioner
Department of Public Property

October 21, 1976

Mr. Robert G. Clem, Chief
Bureau of Resource Regulation
Department of Transportation
2300 South Dirksen Parkway
Springfield, IL 62706

Dear Mr. Clem;

As per your request, transmitted are two (2) copies of drawing Y29. This drawing has incorporated all the suggestions made by the Illinois Department of Conservation.

If there are any additional questions, please contact me.

Sincerely,

David Wyness
General Manager of Water Systems

DW:kk
Enclosure

General Offices: Municipal Building
SPRINGFIELD, ILLINOIS 62701



JIM HENNEBERRY, Commissioner
Department of Public Property

October 21, 1976

Mr. Jerry Turner
Illinois EPA
Division of Water Pollution Control
Permit Section
2200 Churchill Road
Springfield, IL 62706

Dear Mr. Turner;

SUBJECT: Application for a Construction Permit for Contract
3333 -- Ash Pond.

I am resubmitting a copy of the construction permit application for Contract 3333. This application was previously submitted by Mr. Kunshek, the former City Water, Light and Power Environmental Coordinator who has since acquired employment elsewhere.

If there are any questions concerning this matter, please contact me.

Sincerely,

A handwritten signature in black ink, appearing to read "David Wyness", written over a horizontal line.

David Wyness
General Manager of Water Systems

DW:kk
Enclosures

ILLINOIS ENVIRONMENTAL PROTECTION AGENCY
DIVISION OF WATER POLLUTION CONTROL
PERMIT SECTION
Springfield, Illinois 62706

APPLICATION FOR PERMIT OR CONSTRUCTION APPROVAL
WPC-PS-1

1. NAME AND LOCATION:

Name of project: Ash Disposal Pond (Contract 3333)
Municipality or Township Springfield County Sangamon

2. BRIEF DESCRIPTION OF PROJECT: Modification to existing ash disposal pond and wastewater system to enlarge holding capacity and efficiency.

3. DOCUMENTS BEING SUBMITTED: If the project involves any of the items listed below, submit the corresponding schedule, and check the appropriate spaces.

PROJECT

- Private Sewer Connection.....A___ Spray Irrigation..... B___
- Public Sewer Extension.....B___ Septic Tanks..... C___
- Sewer Extension Construct Only.....C___ Industrial Treatment or Pretreatment..... D___ **X**
- Sewage Treatment Works.....D___ Deepwell Injection..... E___
- Excess Flow Treatment.....E___ Cyanide Acceptance..... F___
- Lift Station/Force Main.....F___ Updating Cyanide Acceptance Form..... G___
- Sludge Disposal.....G___ Waste Characteristics..... H___ **X**

Plans: Title Contract 3333 - Ash Pond; Drawings No. Y28, Y29, Y30, Y31, Y32
Y33, Y34 Number of Pages 7

Specifications: Title Contract 3333 - Ash Disposal Pond
Number of Books/Pages 1 book/33 pages

Other Documents (Please Specify) Flow chart attached as Exhibit A

4. This is an Application for: Construction Permit___, Operating Permit___, Joint Construction and Operating **X**, Cyanide Acceptance Permit___.

5. CERTIFICATIONS AND APPROVAL

5.1 Certificate by Design Engineer

I hereby certify that I am familiar with the information contained in this application and that to the best of my knowledge and belief such information is true, complete and accurate.

ENGINEER Karl E. Wolfs 25076
NAME REGISTRATION NUMBER

FIRM Burns & McDonnell

ADDRESS P.O. Box 173
Kansas City, Missouri 64141 PHONE NUMBER 816/333-4375

SIGNATURE Karl E. Wolfs

5.2 Certificate by Applicant(s)

I/We hereby certify that I/we have read and thoroughly understand the conditions and requirements of this Application.

I/We hereby agree to conform with the Standard Conditions and with any other Special Conditions made part of the Permit.

City of Springfield, Illinois

5.2.1 NAME OF APPLICANT FOR PERMIT TO CONSTRUCT City Water, Light and Power Department

Municipal Building 7th & Monroe Springfield Illinois 62701

SIGNATURE

Rudy Kunschek
Environmental Coordinator

DATE

9/3/76

TITLE

Environmental Coordinator

5.2.2 NAME OF APPLICANT FOR PERMIT TO OWN AND OPERATE same as above

same as above

SIGNATURE

Rudy Kunschek
Environmental Coordinator

DATE

9/3/76

TITLE

Environmental Coordinator

5.3 Attested (Units of Government) Not Applicable

DATE

SIGNATURE

TITLE

(CITY CLERK, VILLAGE CLERK, SANITARY DISTRICT CLERK, ET CETERA)

5.4 Applications from non-governmental applicants which are not signed by the owner, must be signed by a principal executive officer of at least the level of vice president, or his duly authorized representative.

5.5 Certificate by INTERMEDIATE SEWER OWNER **This section is NOT APPLICABLE**

I hereby certify that the sewers to which this project will be tributary have adequate reserve capacity to transport the wastewater that will be added by this project without causing a violation of the Environmental Protection Act or Chapter 5 of the Regulations as adopted by the Illinois Pollution Control Board.

Name of sewer system to which this project will be tributary:

NAME OF SEWER SYSTEM OWNER

STREET

CITY

STATE

ZIP CODE

SIGNATURE

DATE

TITLE

5.6 Certificate by Waste Treatment Works Owner **This section is NOT APPLICABLE**

I hereby certify that the treatment works to which this project will be tributary have adequate reserve capacity to treat the wastewater that will be added by this project without causing a violation of the Environmental Protection Act or Chapter 5 of the Regulations as adopted by the Illinois Pollution Control Board.

Name and location of waste treatment works to which this project will be tributary:

TREATMENT WORKS OWNER

STREET

CITY

STATE

ZIP CODE

SIGNATURE

DATE

TITLE

ILLINOIS ENVIRONMENTAL PROTECTION AGENCY
DIVISION OF WATER POLLUTION CONTROL
PERMIT SECTION
Springfield, Illinois 62706

APPLICATION FOR PERMIT OR CONSTRUCTION APPROVAL

WPC-PS-1

1. NAME AND LOCATION:

Name of project: Ash Disposal Pond (Contract 3333)
Municipality or Township Springfield County Sangamon

2. BRIEF DESCRIPTION OF PROJECT: Modification to existing ash disposal pond and wastewater system to enlarge holding capacity and efficiency.

3. DOCUMENTS BEING SUBMITTED: If the project involves any of the items listed below, submit the corresponding schedule, and check the appropriate spaces.

PROJECT

- Private Sewer Connection.....A___ Sprav Irrigation.....
- Public Sewer Extension.....B___ Septic Tanks.....
- Sewer Extension Construct Only.....C___ Industrial Treatment or Pretreatment..... **X**
- Sewage Treatment Works.....D___ Deepwell Injection.....
- Excess Flow Treatment.....E___ Cyanide Acceptance.....
- Lift Station/Force Main.....F___ Updating Cyanide Acceptance Form.....
- Sludge Disposal.....G___ Waste Characteristics..... **X**

Plans: Title Contract 3333 - Ash Pond; Drawings No. Y28, Y29, Y30, Y31, Y32, Y33, Y34 Number of Pages 7

Specifications: Title Contract 3333 - Ash Disposal Pond Number of Books/Pages 1 book/33 pages

Other Documents (Please Specify) Flow chart attached as Exhibit A

4. This is an Application for: Construction Permit___, Operating Permit___, Joint Construction and Operating **X**, Cyanide Acceptance Permit___.

5. CERTIFICATIONS AND APPROVAL

5.1 Certificate by Design Engineer

I hereby certify that I am familiar with the information contained in this application and that to the best of my knowledge and belief such information is true, complete and accurate.

DESIGNER Karl E. Wolfs 25076
NAME REGISTRATION NUMBER

FIRM Burns & McDonnell

ADDRESS P.O. Box 173
Kansas City, Missouri 64141 PHONE NUMBER 816/333-4375

SIGNATURE Karl E. Wolfs

ANTHONY T. DEAN
DIRECTOR

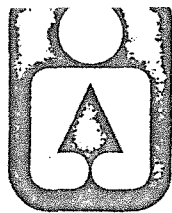

Illinois
Department of
Conservation
Life and land together



WILLIAM A. WATTS
ASSISTANT DIRECTOR

605 STATE OFFICE BUILDING • 400 SOUTH SPRING STREET • SPRINGFIELD 62706
CHICAGO OFFICE - ROOM 100, 160 NO. LASALLE 60601

September 1, 1976

RECEIVED

SEP-07 1976

ENVIRONMENTAL COORDINATOR

Mr. Robert G. Clem, Chief
Bureau of Resource Regulation
Department of Transportation
2300 South Dirksen Parkway
Springfield, IL 62706

Dear Mr. Clem:

We have met with officials from the City Water Light and Power to discuss their proposed plans to relocate a portion of Sugar Creek near Springfield, IL.

The following items have been mutually agreed to by both parties and the Department of Conservation will remove its objections to the project upon receipt of a letter of concurrence from City Water Light and Power.

The items agreed to are:

1. The channel will be constructed with a meander located midway between the beginning of the new channel and its termination point.
2. Riprap will be placed on the outside curves at point A and B as indicated on the enclosed map.
3. Four pools and riffles will be constructed in the new channel at equal intervals. These will consist of low level dams 18-24" high with riprap armory.
4. A 200-foot greenbelt consisting of appropriate trees and shrubs will be established on each side of the new channel. Recommended species include: sycamore, pin oak, green ash, autumn olive, grey dogwood, black walnut, and bush honeysuckle.
5. The new channel will be constructed with 4:1 side slopes and will be seeded down immediately upon completion of the project.
6. The lower portion of the old meander will be left open from point C to B on the enclosed map.

Sincerely,

Richard W. Lutz

Richard W. Lutz, Head
Impact Analysis Section
Division of Long Range Planning

RWL:mjk 7-2
cc: Rudy Kunshek, Jr.
City Water Light & Power

Response to 1st RTP

CWLP-016174

Illinois



Department of Conservation

life and land together

605 WM. G. STRATTON BUILDING • 400 SOUTH SPRING STREET • SPRINGFIELD 62706

CHICAGO OFFICE – ROOM 100, 160 NO. LASALLE 60601

David Kenney, Director • James C. Helfrich, Assistant Director

Ashpond

November 6, 1979

Ms. Mary Ellen Schrader
City, Water, Light, and Power
207 Municipal Building
Springfield, IL 62701

RECEIVED
DEPT. OF PUBLIC PROPERTY
NOV 7 1979
AM 7 8 9 10 11 12 1 2 3 4 5 6 PM

Dear Ms. Schrader:

As you requested in our telephone conversation of November 6, I am forwarding copies of letters pertaining to the 1976 agreement between City, Water, Light and Power and the Illinois Department of Conservation regarding a channel change on Sugar Creek north of Spaulding Dam.

Please feel free to contact me if I may be of further assistance.

Sincerely,

Robert W. Schanzle

Robert W. Schanzle
Resources Planner
Division of Planning

RWS:t

1/2 (76) LC

- Del River
- Sangamon
- Sugar Creek

September 24, 1976

Mr. Robert G. Clem, Chief
Bureau of Resource Regulation
Department of Transportation
2300 South Dirksen Parkway
Springfield, IL 62764

Dear Mr. Clem:

We have received a confirmation from the City Water, Light and Power of Springfield, Illinois, indicating that our recommendations have been incorporated into their plan to relocate a portion of Sugar Creek.

The Illinois Department of Conservation removes its objections to the issuance of the permit.

Sincerely,

Richard W. Lutz, Head
Impact Analysis Section
Division of Long Range Planning

RWL:mjk 7-2
cc: City Water, Light & Power

General Offices: Municipal Building
SPRINGFIELD, ILLINOIS 62701



JIM HENNEBERRY, Commissioner
Department of Public Property

September 9, 1976

Mr. Richard W. Lutz, Head
Impact Analysis Section
Division of Long Range Planning
Department of Conservation
605 State Office Building
400 South Spring Street
Springfield, Illinois 62706

Dear Mr. Lutz;

As per your recommendations the relocation of Sugar Creek will conform to the stipulations outlined in your letter of September 1, 1976. Burns & McDonnell Engineering Co., who are preparing the plans and specifications for this project, will include all the items you requested.

I wish to thank you for your help and cooperation in this matter. I believe your recommendations will improve the aesthetics and environmental impact of this stream modification.

Respectfully,

David Wyness
Sup't., Water Purification

DW:kk

cc: Mr. Robert Clem, Ill. D.O.T.
Mr. Paul Bonansinga, CWL & P

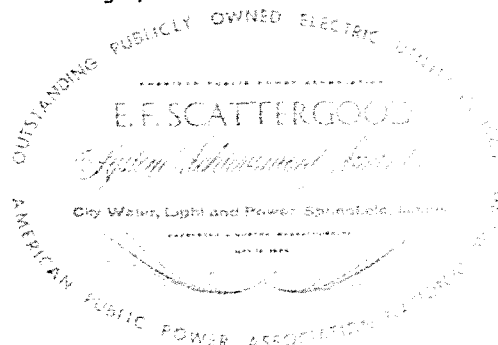

7-2 LC
9-2-76

Ill. R.
Sugar Creek

September 1, 1976

Mr. Robert G. Clem, Chief
Bureau of Resource Regulation
Department of Transportation
2300 South Dirksen Parkway
Springfield, IL 62706

Dear Mr. Clem:

We have met with officials from the City Water Light and Power to discuss their proposed plans to relocate a portion of Sugar Creek near Springfield, IL.

The following items have been mutually agreed to by both parties and the Department of Conservation will remove its objections to the project upon receipt of a letter of concurrence from City Water Light and Power.

The items agreed to are:

1. The channel will be constructed with a meander located midway between the beginning of the new channel and its termination point.
2. Riprap will be placed on the outside curves at point A and B as indicated on the enclosed map.
3. Four pools and riffles will be constructed in the new channel at equal intervals. These will consist of low level dams 18-24" high with riprap armory.
4. A 200-foot greenbelt consisting of appropriate trees and shrubs will be established on each side of the new channel. Recommended species include: sycamore, pin oak, green ash, autumn olive, grey dogwood, black walnut, and bush honeysuckle.
5. The new channel will be constructed with 4:1 side slopes and will be seeded down immediately upon completion of the project.
6. The lower portion of the old meander will be left open ~~from~~ point C to B on the enclosed map.

Sincerely,

Richard W. Lutz, Head
Impact Analysis Section
Division of Long Range Planning

RWL:mjk 7-2
cc: Rudy Kunshek, Jr.
City Water Light & Power

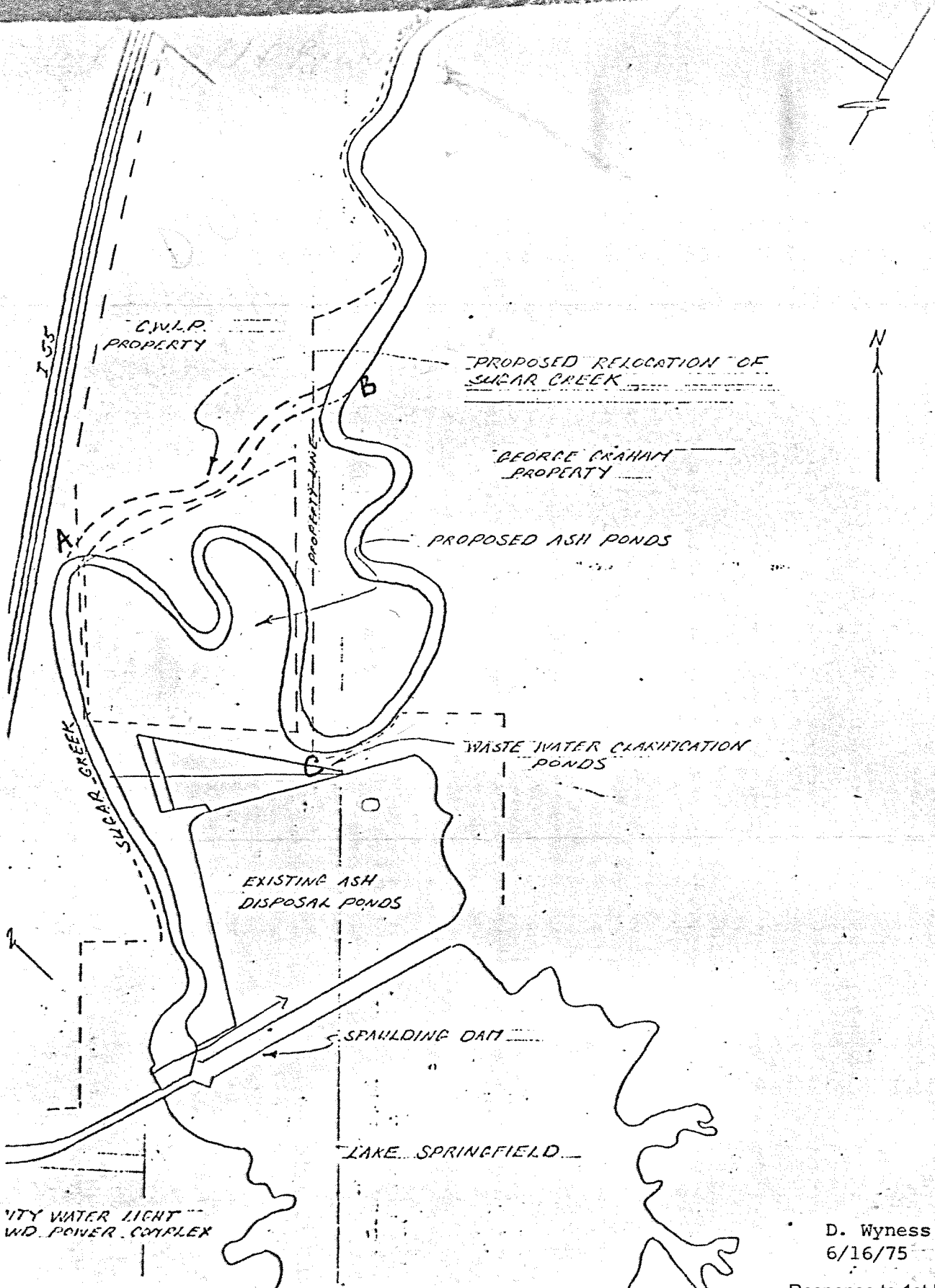

D. Wyness
6/16/75